

Reference No. : 002-2
 Dwg. No. : See attached Table
 Part name : Sheave
 Specification : See attached Table

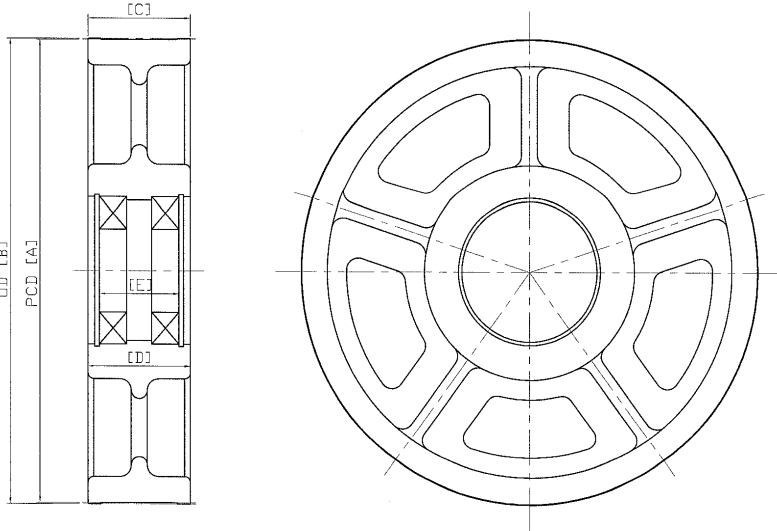

PCD [A]	Rope Dia.	Pitch	No. of groove	Outer Dia. of sheave [B]	Width of sheave [C]	Width of Boss [D]	Distance of bearing [E]	No. of bearing	DWG. No
480	10	17	5	496	94	94	75	#6214	SHAA-10-5-6214
480	10	17	5	490	130	100	80	#6214	SHAA-10-5A77-3214
480	10	17	6	490	130	100	80	#6214	SHAA-10-5A77-3214
480	10	17	7	490	130	100	80	#6214	SHAA-10-5A77-3214
480	10	17	7	490	140	100	80	#6212	SHAA-10-7A78-6212
480	10	17	8	490	140	100	80	#6212	SHAA-10-7A78-6212
480	10	17	9	490	175	120	100	#6212	SHAA-10-9A10-6212
480	10	17	10	490	175	120	100	#6212	SHAA-10-9A10-6212
510	10	17	4	520	110	100	80	#6214	SHAA-10-4A76-6214
510	10	17	5	520	110	100	80	#6214	SHAA-10-4A76-6214
510	10	17	6	520	110	100	80	#6214	SHAA-10-4A76-6214
510	10	17	5	520	130	100	80	#6214	SHAA-10-5A77-3214
510	10	17	6	520	130	100	80	#6214	SHAA-10-5A77-3214
510	10	17	7	520	130	100	80	#6214	SHAA-10-5A77-3214
510	10	17	7	520	140	100	80	#6212	SHAA-10-7A78-6212
510	10	17	8	520	140	100	80	#6212	SHAA-10-7A78-6212
510	10	17	9	520	175	120	100	#6212	SHAA-10-9A10-6212
510	10	17	10	520	175	120	100	#6212	SHAA-10-9A10-6212
560	10	17	4	576	77	77	80	#6214	SHAA-10-4-6214
560	10	17	4	570	110	100	80	#6214	SHAA-10-4A76-6214
560	10	17	5	570	110	100	80	#6214	SHAA-10-4A76-6214
560	10	17	6	570	110	100	80	#6214	SHAA-10-4A76-6214
580	10	17	5	576	94	94	75	#6214	SHAA-10-5-6214
580	10	17	5	570	130	100	80	#6214	SHAA-10-5A77-3214
580	10	17	6	570	130	100	80	#6214	SHAA-10-5A77-3214
580	10	17	7	570	130	100	80	#6214	SHAA-10-5A77-3214
580	10	17	7	570	140	100	80	#6212	SHAA-10-7A78-6212
580	10	17	8	570	140	100	80	#6212	SHAA-10-7A78-6212
580	10	17	9	570	175	120	100	#6212	SHAA-10-9A10-6212
580	10	17	10	570	175	120	100	#6212	SHAA-10-9A10-6212
610	10	17	4	620	110	100	80	#6214	SHAA-10-4A76-6214
610	10	17	5	620	110	100	80	#6214	SHAA-10-4A76-6214
610	10	17	6	620	110	100	80	#6214	SHAA-10-4A76-6214
610	10	17	5	620	130	100	80	#6214	SHAA-10-5A77-3214
610	10	17	6	620	130	100	80	#6214	SHAA-10-5A77-3214
610	10	17	7	620	130	100	80	#6214	SHAA-10-5A77-3214
640	10	17	4	650	110	100	80	#6214	SHAA-10-4A76-6214
640	10	17	5	650	110	100	80	#6214	SHAA-10-4A76-6214
640	10	17	6	650	110	100	80	#6214	SHAA-10-4A76-6214
640	10	17	5	650	130	100	80	#6214	SHAA-10-5A77-3214
640	10	17	6	650	130	100	80	#6214	SHAA-10-5A77-3214
640	10	17	7	650	130	100	80	#6214	SHAA-10-5A77-3214
400	12	19	3	410	70	65	48	#6214	SHAA-12-3-6214
400	12	19	4	410	90	80	60	#6214	SHAA-12-4-6214
400	12	19	5	410	110	100	80	#6214	SHAA-12-5-6214
400	12	19	6	410	130	100	80	#6214	SHAA-12-6-6214
400	12	19	7	410	150	120	100	#6214	SHAA-12-7-6214
450	12	19	3	460	70	65	48	#6214	SHAA-12-3-6214