

Reference No. : 002-1
 Dwg. No. : See attached Table
 Part name : Sheave
 Specification : See attached Table

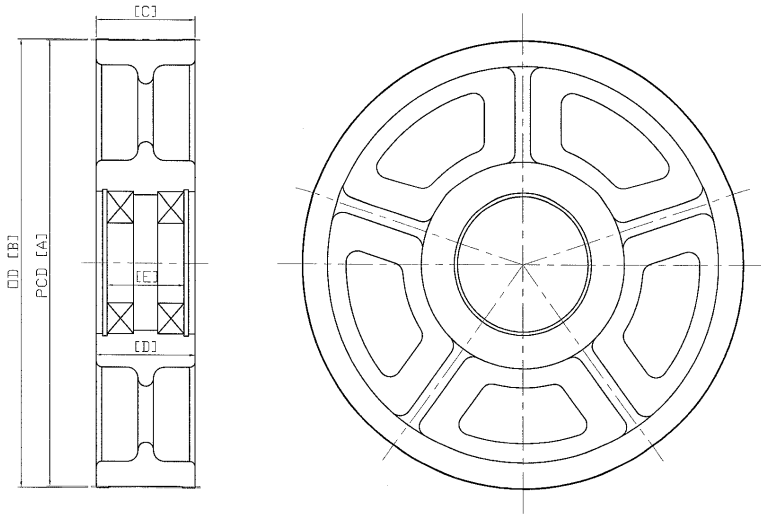

PCD [A]	Rope Dia.	Pitch	No. of groove	Outer Dia. of sheave [B]	Width of sheave [C]	Width of Boss [D]	Distance of bearing [E]	No. of bearing	DWG. No
340	8	15	8	350	130	100	80	#6212	SHAA-340-8-8-6212
400	8	15	6	410	110	100	80	#6212	SHAA-400-8-6-6212
400	8	15	8	410	130	100	80	#6214	SHAA-400-8-8-6214
400	8	15	12	410	185	130	110	#6214	SHAA-400-8-12-6214
480	8	15	8	490	130	100	80	#6212	SHAA-480-8-8-6212
360	10	17	4	376	77	77	60	#6212	SHAA-360-10-4-6212
360	10	17	5	370	90	90	70	#6212	SHAA-360-10-5-6212
400	10	17	4	410	110	100	80	#6214	SHAA-10-4AT6-6214
400	10	17	5	410	110	100	80	#6214	SHAA-10-4AT6-6214
400	10	17	6	410	110	100	80	#6214	SHAA-10-4AT6-6214
400	10	17	5	410	130	100	80	#6214	SHAA-10-5AT7-3214
400	10	17	6	410	130	100	80	#6214	SHAA-10-5AT7-3214
400	10	17	7	410	130	100	80	#6214	SHAA-10-5AT7-3214
400	10	17	6	410	130	100	80	#6212	SHAA-10-6-6212
400	10	17	7	410	140	100	80	#6212	SHAA-10-7AT8-6212
400	10	17	8	410	140	100	80	#6212	SHAA-10-7AT8-6212
400	10	17	9	410	175	120	100	#6212	SHAA-10-9AT10-6212
400	10	17	10	410	175	120	100	#6212	SHAA-10-9AT10-6212
400	10	17	3	416	77	77	60	#6210	SHAA-400-10-3-6210
400	10	17	3	416	77	77	60	#6212	SHAA-400-10-3-6212
400	10	17	4	416	77	77	60	#6212	SHAA-400-10-4-6212
400	10	17	4	402	90	90	70	#6214	SHAA-400-10-4AT5-6214
400	10	17	5	402	90	90	70	#6214	SHAA-400-10-4AT5-6214
400	10	17	5	416	94	94	75	#6212	SHAA-400-10-5-6212
400	10	17	5	410	130	100	80	#6212	SHAA-400-10-5AT6-6212
400	10	17	6	410	130	100	80	#6212	SHAA-400-10-5AT6-6212
400	10	17	8	410	140	100	80	#6212	SHAA-400-10-8-6212
450	10	17	4	460	110	100	80	#6214	SHAA-10-4AT6-6214
450	10	17	5	460	110	100	80	#6214	SHAA-10-4AT6-6214
450	10	17	6	460	110	100	80	#6214	SHAA-10-4AT6-6214
450	10	17	5	460	130	100	80	#6214	SHAA-10-5AT7-3214
450	10	17	6	460	130	100	80	#6214	SHAA-10-5AT7-3214
450	10	17	7	460	130	100	80	#6214	SHAA-10-5AT7-3214
450	10	17	6	460	130	100	80	#6212	SHAA-10-6-6212
450	10	17	7	460	140	100	80	#6212	SHAA-10-7AT8-6212
450	10	17	8	460	140	100	80	#6212	SHAA-10-7AT8-6212
450	10	17	9	460	175	120	100	#6212	SHAA-10-9AT10-6212
450	10	17	10	460	175	120	100	#6212	SHAA-10-9AT10-6212
450	10	17	5	460	130	100	80	#6212	SHAA-400-10-5AT6-6212
450	10	17	6	460	130	100	80	#6212	SHAA-400-10-5AT6-6212
450	10	17	4	466	77	77	60	#6212	SHAA-450-10-4-6212
450	10	17	4	452	90	90	70	#6214	SHAA-450-10-4AT5-6214
450	10	17	5	452	90	90	70	#6214	SHAA-450-10-4AT5-6214
450	10	17	5	460	110	100	80	#6214	SHAA-450-10-5-6214
480	10	17	4	496	77	77	60	#6214	SHAA-10-4-6214
480	10	17	4	490	110	100	80	#6214	SHAA-10-4AT6-6214
480	10	17	5	490	110	100	80	#6214	SHAA-10-4AT6-6214
480	10	17	6	490	110	100	80	#6214	SHAA-10-4AT6-6214